



547 Library Street, San Fernando, CA 91340 U.S.A.

Phone: (818) 838-3025 Fax: (818) 838-3725

INSTALLATION AND SERVICE MANUAL

MEDI-VUE ILLUMINATED MAGNIFYING LIGHT



MEDI-VUE ILLUMINATED MAGNIFIER

GENERAL INSTRUCTIONS

The Medi-Vue Illuminated Magnifier is a high quality product from Medical Illumination International Inc. *Please read the operating instructions before installing and using the fixture.*

GENERAL INFORMATION

The shipping carton contains a Head/Arm assembly and the mounting system intended for your model number. **NOTE:** There are three shipping cartons for the Floor Stand model. One carton contains the Head/Arm assembly, one contains the floor base with casters, and the third contains the upright.

- Open the carton(s) and remove all of the contents. Take care when removing the light as the arm assembly will want to spring open. Be careful not to damage items (e.g. glass lens or lamps) as they are removed from the container. While unpacking the carton, thoroughly check for all items that belong to the model you have purchased (See Figure 1). You should have the Medi-Vue Head/Arm assembly, a lens cover and the mounting hardware for your model.

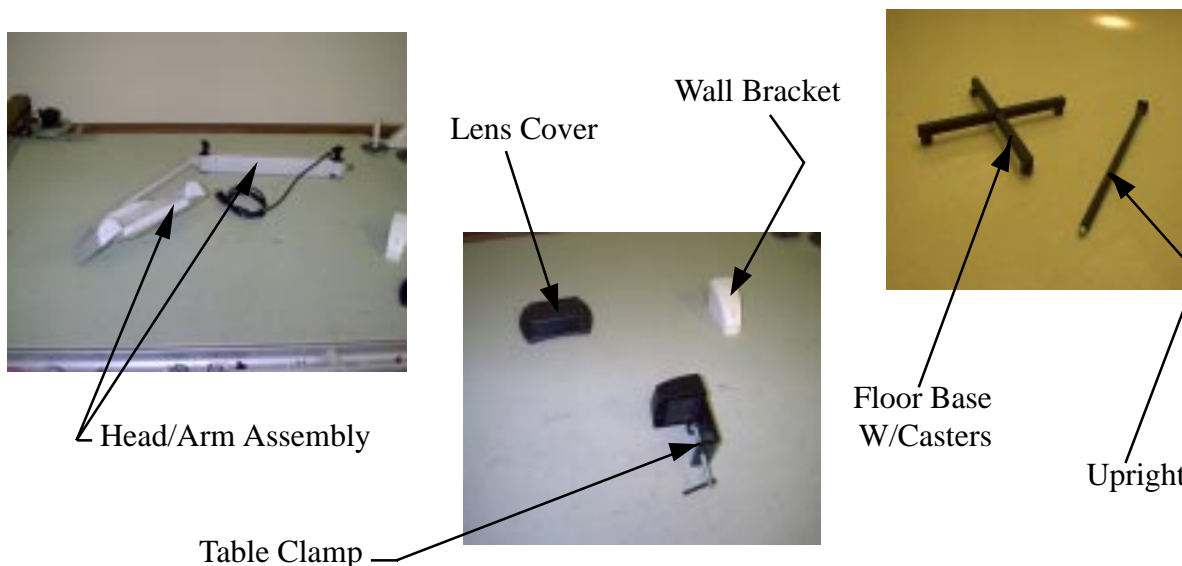

FIGURE 1

PREPARING THE AREA FOR USE (PRE-INSTALLATION)

- The desired area of installation should be flat, clean and clear to allow the Medi-Vue Illuminated Magnifier its greatest range of movement.
- Electrical connection should be provided within 6'-0" (1.92m) of the desired location of the Medi-Vue as the power cord is 6'-6" (2.00m) in length.

INSTALLING THE MEDI-VUE MAGNIFIER

- **Table/Shelf Mounted** (Model #'s 045011, 045041) Attach the table clamp to the rear or side edge of the work surface. **Do Not** use the table clamp on a table or shelf surface with a thickness greater than 2- 1/2". Insure the clamp is tightened sufficiently. If you prefer to have a permanent mounting, you can separate the plastic base from the metal table clamp and fasten the base directly to the work surface. Keep the table clamp in a safe place for future use.
- **Wall Mounted** (Model #'s 045012, 045042) Fasten the plastic wall bracket to the desired wall location with (3) #10 diameter x 3" long (minimum length required) flat head wood screws. Anchor the bracket directly to a wall stud. If the bracket is to be fastened to a metal frame building, use the appropriate type of fastener to attach the unit to the metal stud.
- **Portable Floor Stand Mount** (Model #'s 045017, 045047) (See Figure 2) Set the floor base on a solid floor in the position shown. (See Figure 3) Place the split lockwasher over the 5/8" hex bolt and insert the bolt into the hole from the bottom of the base. Slip the internal tooth washer over the hex bolt from the top hole of the base. Insert the upright into the top hole of the base while holding the hex bolt in place. Rotate the upright in the direction shown to seat the upright and hex bolt. Use a 7/8" wrench to firmly tighten the hex bolt. Turn in the direction shown. Attach the plastic mounting base to the top of the upright with the 4 screws provided.

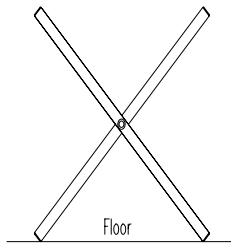

FIGURE 2

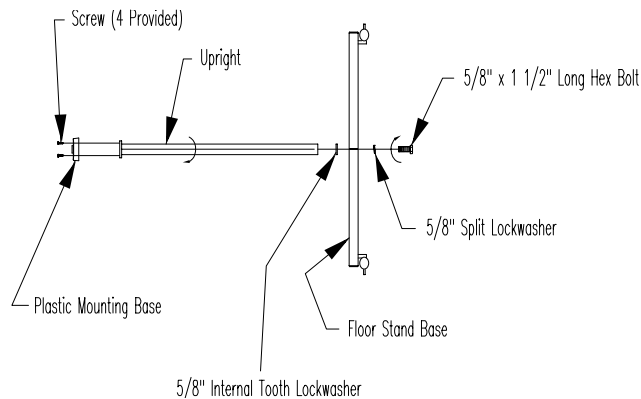

FIGURE 3

After the mounting hardware has been assembled or fastened to its location, the Head/Arm assembly can be attached. Orient the Head/Arm and insert the mounting pin vertically into the hole. **Do Not** force the pin into the mount at an angle. **CAUTION:** Forcing the pin in at an angle will not allow the light to sit properly causing the light to fall over or the pin may not rotate within the mounting hole. If the Head/Arm is installed correctly, the base of the arm will sit completely and evenly on the mount (See Figure 4).

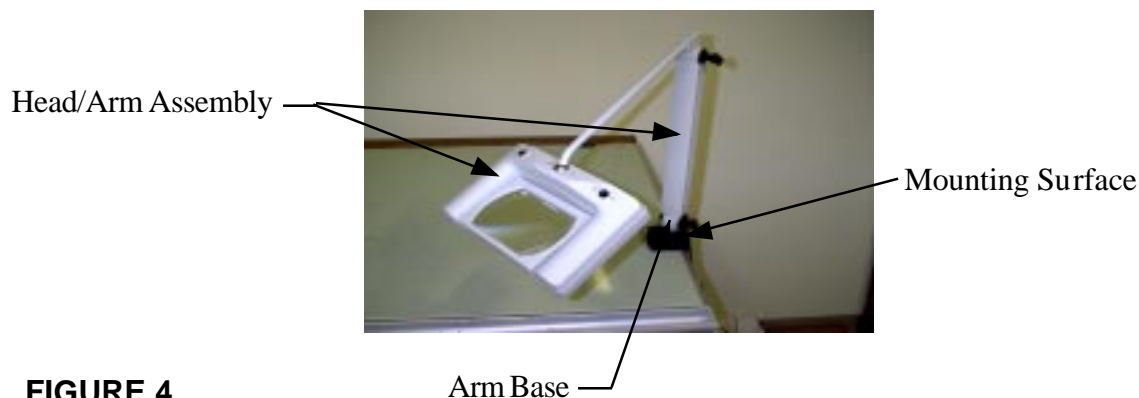

FIGURE 4

PRECAUTIONS BEFORE OPERATING THE LIGHT

There are a few key points about the Medi-Vue Illuminated magnifier that you must understand.

- This light **IS NOT** water and/or dust proof.
- The light **MUST** be used in such a way that water or other liquids **CANNOT** penetrate the housing.
- Replace damaged parts **IMMEDIATELY**.
- Replace the fluorescent lamps **ONLY** with ones of the same type and power (Voltage & Wattage Rating).
- Dispose of old lamps properly in accordance with your local, state and/or federal law. Compact fluorescent lamps contain trace amounts of mercury and phosphate powders commonly classified as hazardous waste.
- You have the responsibility to comply with the regulations concerning the preventative measures for health protection.
- The user must not make any change or modification to any part of the lamp except to occasionally replace the fluorescent lamps.
- Whenever the unit is not in use, **ALWAYS** replace the lens cover to prevent the possibility of risk of fire due to the concentrating effect the lens has on sunlight.
- **DANGER:** Risk of explosion if used in the presence of flammable anesthetics. Use the light in an area free of flammable gases.

OPERATION

- Before plugging the cord into the power source and placing the light into operation, check that the connection voltage corresponds to the rated voltage specified on the rating plate.
- (See Figure 5) Using a small flat-bladed screwdriver, lift the dust cover from its holding clips and remove it. Remove and discard the Styrofoam blocks next to each lamp. These were used to secure the lamps for transport. Replace the dust cover.

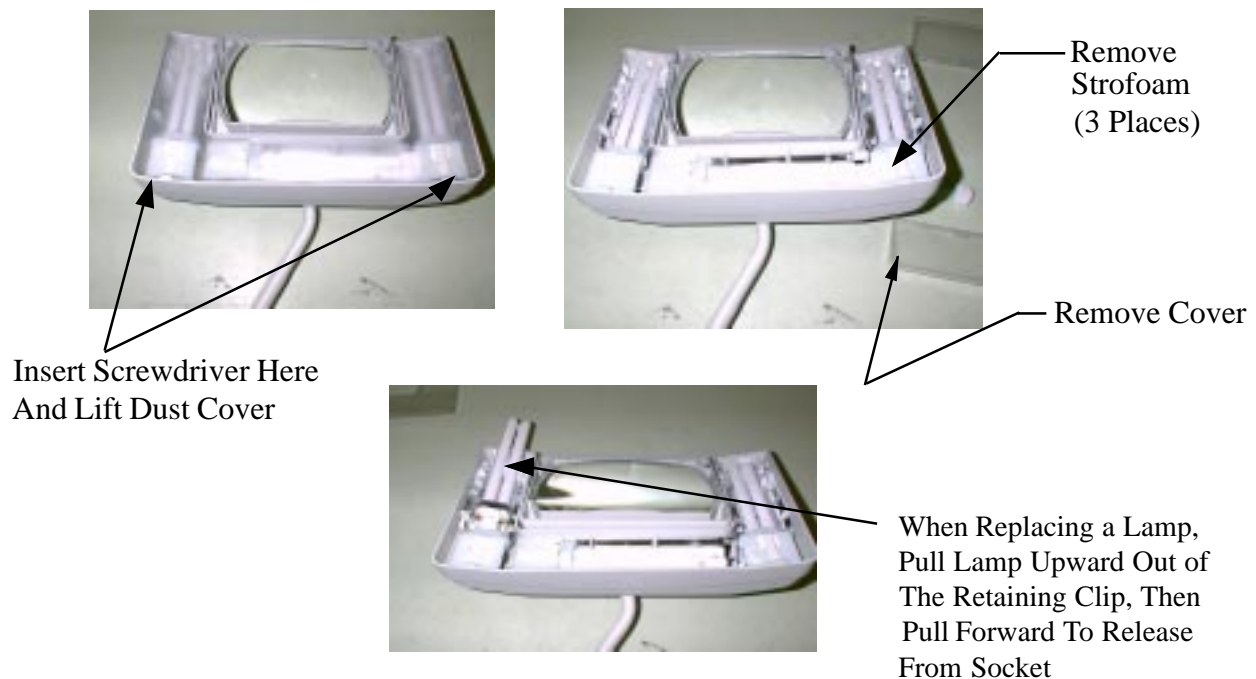

FIGURE 5

There are two switches located on the top of the lighthouse. One switch controls the power supply to the two outer lamps. The other switch allows you to select the third (rear) lamp independently of the two side lamps. The lamp can be switched on and off on top of the reflector housing. The lens can be rotated to a desired position. Grasp the lens with one hand and pivot it into position.

CLEANING

The light is not waterproof and must not be immersed in water. The best way to clean the fixture is with a clean, soft dampened cloth. Use a mild household cleaning soap compatible with paints and plastics to clean the metal parts as well as the plastic housing. The lens can be cleaned with ordinary glass cleaner. Do not use harsh detergents or abrasive products of any kind. Dust that accumulates in the light housing can be vacuumed out.

REPLACING THE FLUORESCENT LAMPS

If the fluorescent lamp(s) does not work you should first check if it is plugged into the power supply, the switch is in the on position and that power is present in the area.

- **Always allow the lamps to cool down before attempting to replace them.**

1. Make sure the unit is unplugged from the power source and the switch is in the off position.
2. (See Figure 5) Using a small flat-bladed screwdriver, lift the dust cover from its holding clips and remove it.
3. Lift the glass tube end of the compact fluorescent lamp slightly and pull firmly to release from the lampholder. Lift the lamp free of the housing. Take care not to knock the lamp on any objects in the area. This may cause them to break releasing a tiny amount of mercury and phosphor powder.
4. Replace the lamps only with the same type and wattage rating that came with the light. **Use only 9 Watt compact fluorescent tubular lamps** (Medical Illumination Part No. 0001704)
5. Carefully insert the new lamp checking to insure the pins on the base are oriented correctly to slide into the lampholders. Ensure it "clicks" positively into place, and then seat the lamp back into the retaining clip.
6. Replace the dust cover.

ADJUSTING THE FRONT ARTICULATION ARM

(See Figure 6) The front articulation arm can be adjusted by means of the adjusting wing nut. The articulation must be adjusted so that the light is easy to move and it should also remain in the required position. **CAUTION:** Loosen or tighten the articulation joint lightly (3 to 4 turns maximum). Turning the adjustment nut too much will disengage the relief spring and it would have to be factory reset.

ADJUSTING THE REAR ARM SPRING BALANCE

1. (See Figure 6) Tilt the light fully back.
2. Loosen the wing nut approximately 3 to 4 turns maximum.
3. Move the arm to the desired position.
4. Tighten the wing nut until the required braking effect is achieved.

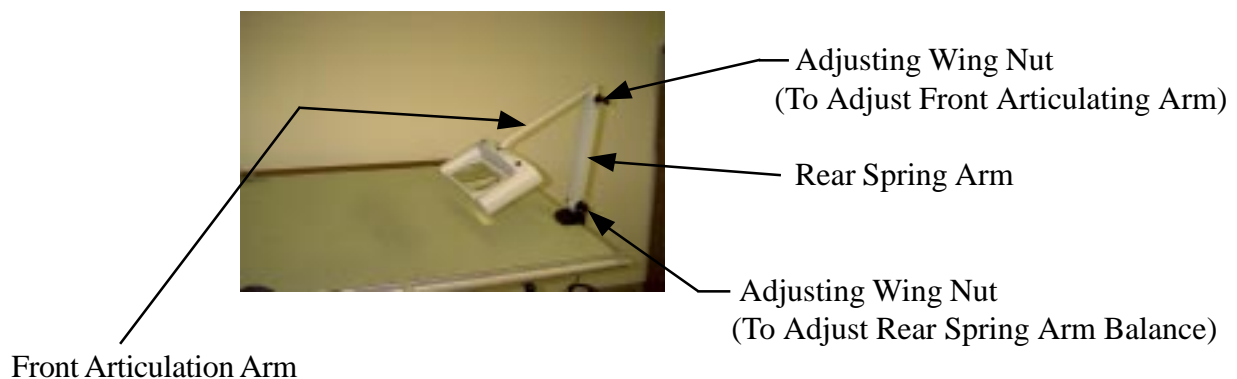

FIGURE 6

Medical Illumination International, Inc.

Lighting Equipment

Limited Warranty

Medical Illumination International, Inc. Lighting Equipment is warranted against defective material and/or workmanship, excluding normal replacement parts (e.g. bulbs or glass items), for a period of three (3) years from the date of shipment. This warranty applies exclusively to the repair or replacement of parts recognized as defective by Medical Illumination International, Inc., are in normal use, and have not been modified or repaired by unauthorized personnel. This warranty supersedes all other guarantees or warranties, expressed or implied.

In the event of a failure covered under this warranty, please take the following action.

1. Call the Medical Illumination Customer Service Department at (818) 838-3025.
 - A. Be prepared to give the model number, serial number, and full description of the failure.
 - B. Customer Service will attempt to solve the problem over the phone. If it becomes necessary to send the product to the factory for repair, Customer Service will provide a Return Authorization number. No product should be returned without a Return Authorization number.
2. Carefully package the light component (light head, arm assembly, or mount assembly) and return it, freight prepaid and insured, with the Return Authorization number clearly marked on the box, to:

Medical Illumination International, Inc.
547 Library Street
San Fernando, CA 91340

Damage resulting from inadequate packing is not covered by this warranty and shipping insurance does not cover damage from inadequate packing.

We recommend that the package be insured against loss or in-transit damage. Medical Illumination can not be responsible for in-transit loss or damage.

3. DAMAGE TO THE PRODUCT RESULTING FROM TAMPERING, ACCIDENT, ABUSE, NEGLIGENCE, OR OTHER CAUSES UNRELATED TO PROBLEMS WITH MATERIAL AND/OR WORKMANSHIP, ARE NOT COVERED BY THIS WARRANTY.
4. Warranty may be voided if equipment is found to have been installed incorrectly, resulting in equipment failure.
5. This warranty does not cover any labor costs associated with removing, re-packaging for shipment or reinstalling this product. Such costs are the responsibility of the purchaser.
6. Medical Illumination International, Inc. will evaluate the returned product, repair as appropriate, and ship the product back to you freight paid.
7. In the event non-warranty damage or failure is discovered, you will be contacted before repairs are performed.

